

**VIVA FLORIDA LANDSCAPE DEMONSTRATION GARDENS GRANT  
FINAL REPORT**

(for projects contracted under Letter of Agreement)

**Project location:** UF/IFAS Extension Orange County, 6021 S. Conway Rd. Orlando, FL 32812

**Project manager name:** [REDACTED]

**Project manager email:** [REDACTED]

**Project manager phone:** [REDACTED]

Planting dates: Sept. 29, 2020 and Oct. 29, 2020

Reporting period: Jan. 1 – June 30, 2021

Report due: July 31, 2021

**List all species (preferably by Latin/scientific name) that were part of this wildflower landscaping project.**

Species added to our Wildflower Meadow for the expansion and enhancement include *Liatris spicata*, *Vernonia angustifolia*, *Vernonia gigantea*, *Asimina obovate*, *Trichostema dichotomum*, *Sporobolus junceus*, *Ageratina aromatica*, *Sorghastrum secundum*, *Sisyrinchium angustifolium*, *Senna Mexicana*, *Hypericum tenuifolium*, and *Scutellaria* sp. In addition to the plant material purchased, seeds from *Liatris spicata*, *Asclepias incarnata* were collected from plants on site and replanted in bare spots. The summary of invoices is below.

**Provide detail of site prep, construction and installation methods.**

Prior to planting the site was thoroughly hand weeded. Torpedo grass was sprayed with herbicide and dug up. Plants were purchased mostly in 1-gallon size and planted by Orange County staff, agent, and volunteers. Participants in our Wildflower Workshop also helped transplant plants in the Wildflower Meadow. Plants were watered in after planting.

**During the grant cycle, the wildflower display is best described as (select one from each column):**

- |  |  |
|--|--|
| <input type="checkbox"/> Extremely showy             | <input checked="" type="checkbox"/> Extremely successful |
| <input checked="" type="checkbox"/> Moderately showy | <input type="checkbox"/> Moderately successful           |
| <input type="checkbox"/> Slightly showy              | <input type="checkbox"/> Somewhat successful             |
| <input type="checkbox"/> Not very showy              | <input type="checkbox"/> Not successful                  |

**Provide any additional comments about the display or success of the planting.**

The planting went very well. It helped that this was an already established wildflower site. The site just needed some weeding to prepare for planting. Planting was very successful and the site also benefitted from the reseeding of existing plants. This spring the Wildflower Meadow was completely in bloom with black eyed Susan and looked spectacular. The native milkweed species are in bloom now. There is a great mix of colors and something going in the meadow year-round.

**If part or all of your planting failed, please explain why it failed (e.g. succumbed to weed pressure, accidental mowing, flooding, etc.), what you are doing to help re-establish it, and how you are educating the public about the failed planting.**

At least 90% of the plants installed during this grant cycle survived. A few plants were lost including the paw paw to unknown causes. We will continue to plant and expand the Wildflower Meadow into the foreseeable future.

**Were any educational programs held onsite that featured or included the native wildflower planting? If yes, please describe the activities, outcomes and estimated number in attendance.**

During the planting period (Sept. 20 – Oct. 29, 2020) we had several groups of people and individuals visit and interact with the garden. Two public events were scheduled that allowed up to 5 people to take an in-person Wildflower Workshop with Tia Silvasy. These 8 participants were given a guided tour of the meadow and learned how to plant wildflowers from seed and transplant native plant materials from 1-gallon pots into our Wildflower Meadow. Participants received the 20 Easy Wildflowers to Grow publication and two packs of native wildflower seed to take home. During the planting period the Wildflower Meadow was also visited by Dr. Patrick Bohlen and a group of 14 UCF students who are in the landscape and pollinators club. These students were also given a guided tour and learned to plant seeds and transplant native plants in the Wildflower Meadow. Mandy Morgan, Vice President of the Tarflower Chapter of the Florida Native Plant Society also visited the garden. Mandy wrote the scripts for four videos which were recorded, edited and posted on Facebook and/or YouTube on the theme of Native Plants for Beginners.

**Were any educational materials (e.g. identification guides, descriptive signage, etc.) prepared in conjunction with the planting? If yes, tell us what they were. If possible, include a photo or PDF of the materials.**

New signs were created to replace old signs in the Wildflower Meadow. A pdf of the signs is attached.

**If possible, provide an estimation of how many people viewed or visited the planting throughout the first year.**

In addition to the 22 attendees from the wildflower workshop and UCF visit we had an additional 163 people who visited on guided garden tours, and another estimated 8,000 visitors to our garden in the past 10 months. The visitation was greatly reduced this past year due to COVID-19.

**Did the wildflower planting receive publicity via one or more of the following outlets? If yes, provide the publication or source name, publication date, and link to the article, post or video (or attach a copy/scan if printed). Indicate if the publicity included information about the environmental, historical and/or cultural significance of Florida's native wildflowers.**

- |                                     |                                   |
|-------------------------------------|-----------------------------------|
| <input type="checkbox"/> Newspaper  | X Other social media              |
| <input type="checkbox"/> Newsletter | <input type="checkbox"/> Local TV |
| <input type="checkbox"/> Website    | X YouTube                         |
| X Facebook                          |                                   |

An article of the Wildflower planting was included in the "In Your Backyard" newsletter by Teresa Watkins in October 2020 Issue 19.  
<https://us13.campaign-archive.com/?u=2ed0046e4eb3f7da0cff8f467&id=6e74d6df2a>

Below are links and number of views/reach for the seven videos created during our project:

Love grass: A Native Plant for Beginners (3,500 reach as of July 21, 2021)

<https://www.facebook.com/GardenFlorida/videos/207598640855843/>

Milkweed Plants for Beginning Gardeners (5,700 reach as of July 21, 2021)

<https://www.facebook.com/GardenFlorida/videos/371863607355585/>

Beginner Plants for Florida Native Gardens (5,700 reach on Facebook, 137 views on YouTube as of July 21, 2021)

<https://www.facebook.com/GardenFlorida/videos/766656820732682/>

<https://youtu.be/niKYZaNbPJA>

Virtual Tour of our Wildflower Meadow (2,300 views as of July 21, 2021)

<https://www.facebook.com/GardenFlorida/videos/264798058110815/>

Flowers from Seed: How to Direct Sow Florida Native Wildflower Seed (7,800 views as of July 21, 2021)

<https://www.facebook.com/GardenFlorida/videos/1232515133831569/>

Plant Species for our Native Wildflower Meadow (44 views on YouTube, 764 views on Facebook)

[https://www.youtube.com/watch?v=Nh-YXU\\_ZWSU&t=1s](https://www.youtube.com/watch?v=Nh-YXU_ZWSU&t=1s)

Plant Florida Native Swamp Milkweed for Butterflies (1,800 views as of July 21, 2021)

<https://www.facebook.com/282185891819708/videos/253298802419744>

Outreach was conducted using social media platforms to spread the word about our Wildflower Meadow and share educational tips on plant selection, maintenance, and benefits of native plants and wildflowers. Photos were posted on Instagram [https://www.instagram.com/oc\\_extension/](https://www.instagram.com/oc_extension/) using Florida Wildflower hashtags such as #flawildflowers2020 #flawildflowers #floridanativeplants.

Here are links to 10 Instagram posts:

Native wildflowers attract pollinators

<https://www.instagram.com/p/CRFE8BeB1P0/>

Coreopsis leavenworthii blowing in the wind

<https://www.instagram.com/p/CQRNR0iHbty/>

Rattlesnake master in bloom

<https://www.instagram.com/p/CQOiwuRBuAT/>

Monarch caterpillar on swamp milkweed

<https://www.instagram.com/p/CPk-2mehBpv/>

Black eyed Susan in bloom

<https://www.instagram.com/p/COTVsfihcYc/>

Dog Fleabane in bloom

<https://www.instagram.com/p/CNC0M6zBrNC/>

Trimming back the grasses in February

<https://www.instagram.com/p/CLE82sxBGka/>

Maryland golden aster in bloom

<https://www.instagram.com/p/CG8A9NChpEU/>

Chapman's aster in bloom with name tag

<https://www.instagram.com/p/CGU00CoBpsN/>

Blazing star seed planting

<https://www.instagram.com/p/CFyKUgABltU/>

Tia Silvasy holding plant on planting day

<https://www.instagram.com/p/CFvEz64hTkr/>

Virtual tour of Wildflower Meadow before planting

<https://www.instagram.com/p/CDUhtDMBZ0-/>

**Please tell us anything else you'd like us to know about the planting or how it has been received by the community.**

The planting was a great success. Many organizations and individuals were involved in the wildflower meadow at all stages of the project. It is an area frequented by visitors in our Exploration Gardens. We have had an excellent reach over social media with our photos and videos. The educational workshops were a great way to engage participants and educate them about native wildflowers. This site will continue to be a free and open to the public educational resource for the community.

**When submitting your report, please include the following attachments:**

- X Final design plan (Note: our final design was created in two layers: one for perennials and one with grasses/shrubs)
- X Itemized expense report for entire project attached
- X Receipts for all related expenses (4 receipts from Green Isle Gardens)
- X Photos before, during and after the installation (photos were included in the initial and progress report)
- X Photos showing an overview of the garden in bloom; an educational program taking place in the garden; and/or volunteers working in the garden (photos were included in the progress report)
- X Maintenance plan/schedule for the next year attached
- X Educational programming/materials scheduled/planned for the next year that relate to or include the demonstration garden attached



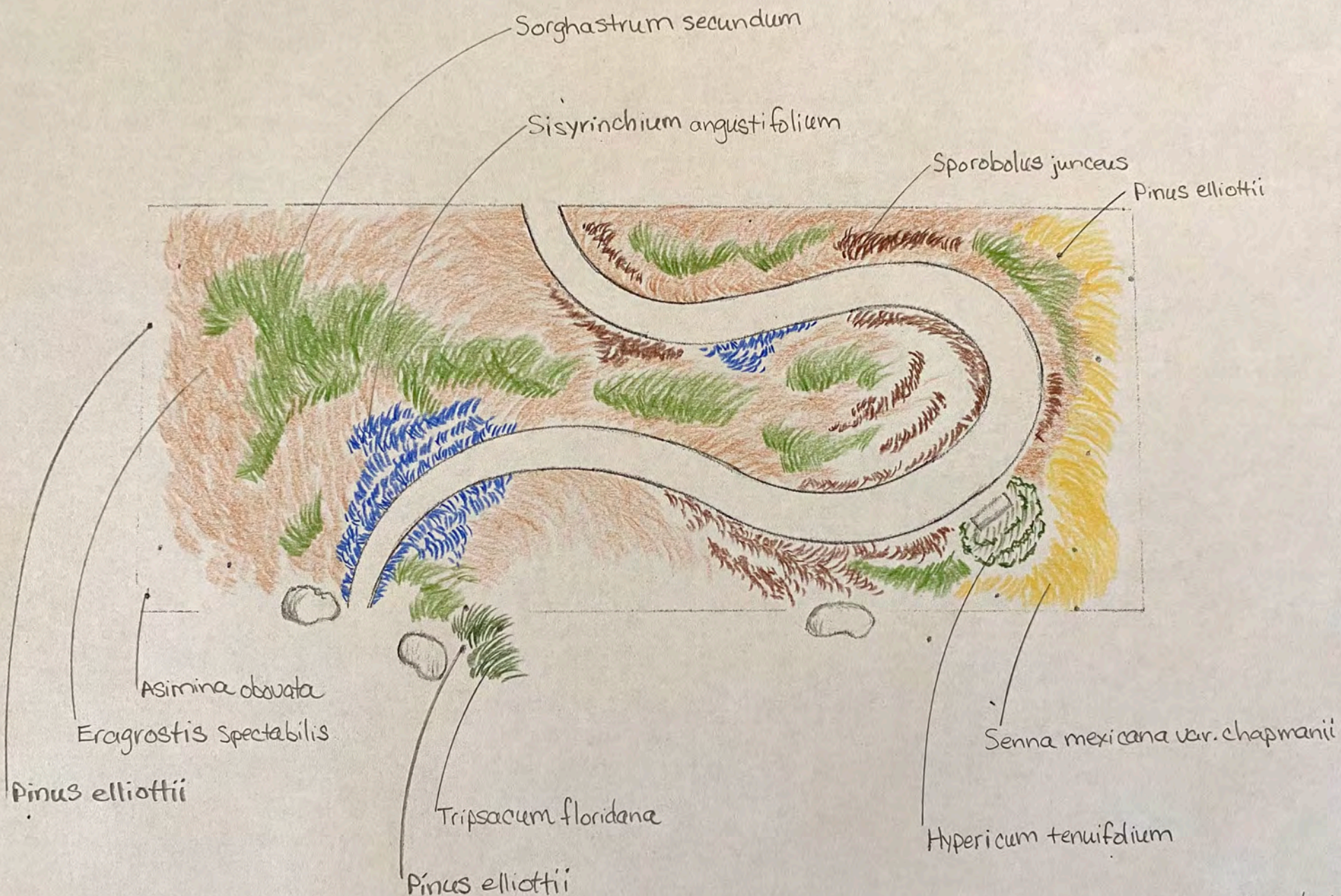

grass and shrub layer

UF IFAS Native Meadow  
not to scale | N ↑ | AE



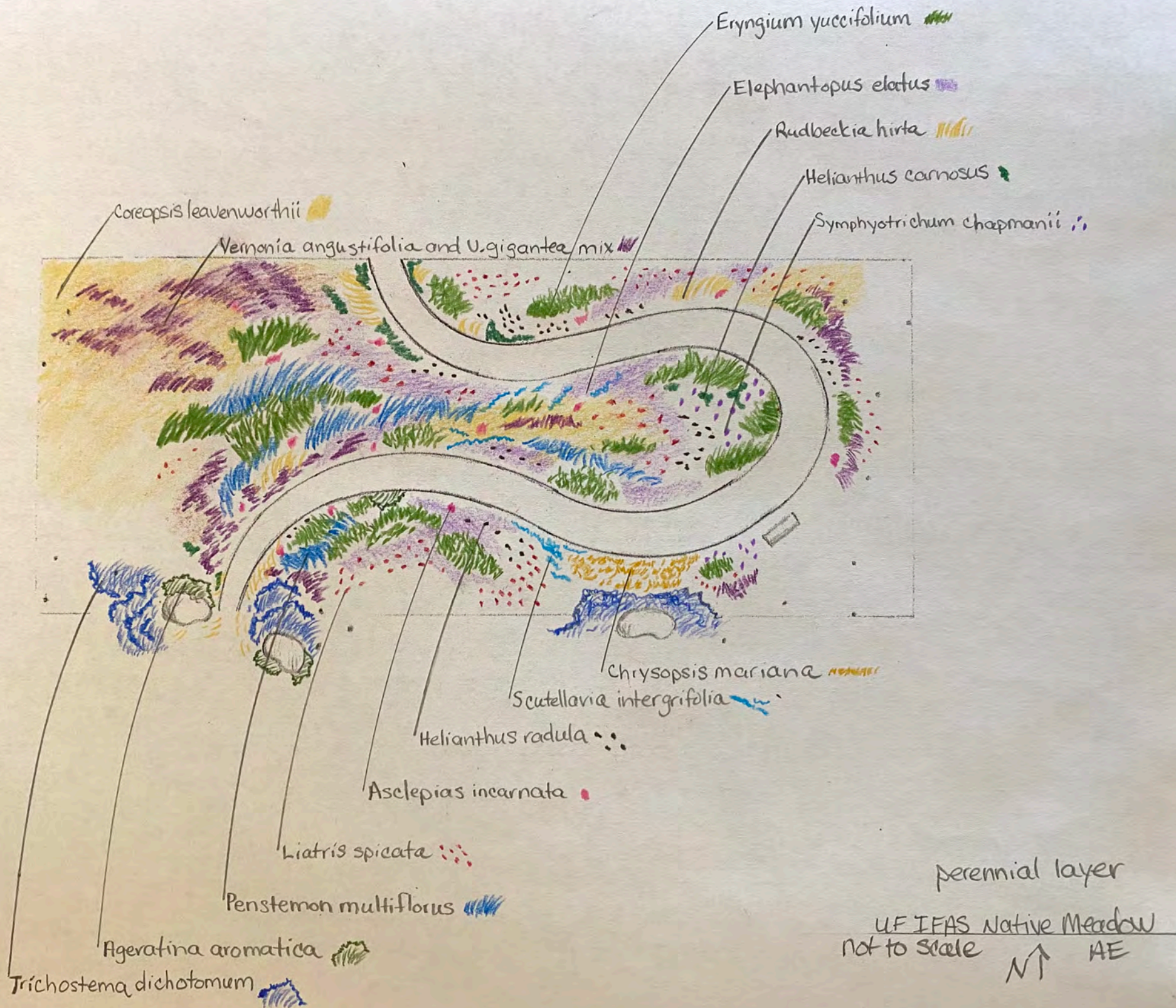

## Itemized Expense Report

### Purchases

<b>Date</b>	<b>Vendor</b>	<b>Amount</b>
9/21/2020	Green Isle Gardens	182.50
10/9/2020	Green Isle Gardens	142.00
10/19/2020	Green Isle Gardens	47.50
10/26/2020	Green Isle Gardens	129.50
	<b>Total</b>	<b>501.50</b>





Black-eyed Susans  
provide support and protection  
for tall flowers.  
• fill in spaces around seedlings  
that would otherwise be occupied  
by weeds.  
• control soil erosion.  
• provide food and cover for wildlife.

Black-eyed Susans  
are a hardy perennial  
that can tolerate  
a wide range of soil  
conditions.















*Vernonia angustifolia*

## COMMON IRONWEED

Florida Native

*Butterfly Nectar Wildflower Gardens*



Photograph Courtesy of Jeff McMillian @ USDA-NRCS Plant Database

*Andropogon virginicus* var. *glaucus*

## CHALKY BLUESTEM

Florida Native

*Clumping Warm Season Native Grass*



Photograph Courtesy of regionalconservation.org Shirley Denton

*Eryngium yuccifolium*

## RATTLESNAKE MASTER

Florida Native

*Attracts Large Number of Native Bees*



Photograph Courtesy of ladybirdwildflower.org Sally & Andy Wasowski

*Liatris spicata*

## BLAZING STAR

Florida Native

*Butterfly Nectar Wildflower Gardens*



Photograph Courtesy of florida.plantatlas.usf.edu Walter Hodge

*Sorghastrum secundum*

## LOPSIDED INDIANGRASS

Florida Native

*Natural Landscapes Wildflower Gardens*



Photograph Courtesy of regionalconservation.org Shirley Denton

*Ageratina jucunda*

## LITTLE WHITE AGERATINA

Florida Native

*Attracts Butterflies and Bees*



Photograph Courtesy of florida.plantatlas.usf.edu Bob Upcavage



*Carphephorus odoratissimus*

## **VANILLA LEAF**

**Florida Native**

*Butterfly Nectar Wildflower Gardens*



Photograph Courtesy of ladybirdwildflower.org Joseph Allan Tauscher

*Penstemon multiflorus*

## **WHITE BEARDTONGUE**

**Florida Native**

*Butterfly Larva Wildflower Gardens*



Photograph Courtesy of florida.plantatlas.usf.edu Bob Bierman

*Scutellaria integrifolia*

## **HELMET SKULLCAP**

**Florida Native**

*Attracts Pollinators Wildflower Gardens*



Photograph Courtesy of florida.plantatlas.usf.edu Shirley Denton

*Carphephorus paniculatus*

## **DEER TONGUE**

**Florida Native**

*Butterfly Nectar Wildflower Gardens*



Photograph Courtesy of florida.plantatlas.usf.edu Shirley Denton

*Phoebanthus grandiflorus*

## **FALSE SUNFLOWER**

**Florida Native**

*Attracts Butterflies and Bees*



Photograph Courtesy of florida.plantatlas.usf.edu Dennis Girard

*Solidago stricta*

## **WAND GOLDENROD**

**Florida Native**

*Attracts Butterflies and Native Bees*



Photograph Courtesy of florida.plantatlas.usf.edu Shirley Denton



*Helianthus carnosus*

**LAKESIDE SUNFLOWER**

**Florida Native**

*Attracts Butterflies and Bees*



Photograph Courtesy of [florida.plantatlas.usf.edu](http://florida.plantatlas.usf.edu) Dennis Girard

*Eragrostis elliottii*

**ELLIOTT LOVEGRASS**

**Florida Native**

*Attracts Small Birds Larva Host Plant*



Photograph Courtesy of [floridanativeplantsociety.org](http://floridanativeplantsociety.org) Gimny Stibolt

*Sporobolus junceus*

**PINEYWOODS DROPSEED**

**Florida Native**

*Bunching Low Growing Grass*



Photograph Courtesy of [floridanativeplantsociety.org](http://floridanativeplantsociety.org) Shirley Denton

*Aristida stricta*

**WIREGRASS**

**Florida Native**

*Attracts Birds Naturalistic Landscapes*



Photograph Courtesy of [florida.plantatlas.usf.edu](http://florida.plantatlas.usf.edu) Betty Wargo

*Eragrostis spectabilis*

**PURPLE LOVEGRASS**

**Florida Native**

*Border Grass Attracts Small Birds*



Photograph Courtesy of [floridanativeplantsociety.org](http://floridanativeplantsociety.org) Betty Wargo

*Helianthus radula*

**RAYLESS SUNFLOWER**

**Florida Native**

*Attracts Pollinators Wildflower Gardens*



Photograph Courtesy of [floridanativeplantsociety.org](http://floridanativeplantsociety.org) Shirley Denton



*Asclepias perennis*

**WHITE MILKWEED**

**Florida Native**

*Larva Host Monarch Butterfly*



Photograph Courtesy of ladybirdjohnsonwildflower.org Alan Cressler

*Coreopsis leavenworthii*

**TICKSEED**

**Florida Native**

*Nectar and Pollen Honey & Native Bees*



Photograph Courtesy of floridanativeplantsociety.org Roger Hammer

*Ruellia caroliniensis*

**WILD PETUNIA**

**Florida Native**

*Butterfly Nectar and Larva Host Plant*



Photograph Courtesy of ladybirdjohnsonwildflower.org R W Smith

*Asclepias tuberosa*

**BUTTERFLYWEED**

**Florida Native**

*Attracts Large Number of Native Bees*



Photograph Courtesy of ladybirdjohnsonwildflower.org Alan Cressler

*Rudbeckia hirta*

**BLACK-EYED SUSAN**

**Florida Native**

*Butterfly Nectar and Larva Host Plant*

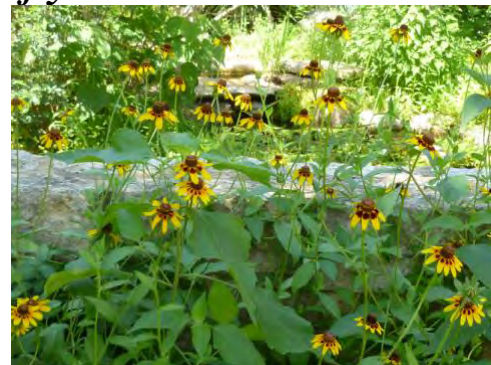

Photograph Courtesy of ladybirdjohnsonwildflower.org Page Lee

*Chrysopsis mariana*

**GOLDENASTER**

**Florida Native**

*Attracts Pollinators Wildflower Gardens*



Photograph Courtesy of ladybirdwildflower.org Stephanie Brundage



*Andropogon ternarius*

## **SPLITBEARD BLUESTEM**

**Florida Native**

*Birds eat seeds/Native Bees use for nesting*



*Photograph Courtesy of Virginia plant atlas.org Michael Terry*

*Coreopsis floridana*

## **FLORIDA TICKSEED**

**Florida Native**

*Nectar plant for butterflies*



*Photograph Courtesy of regionalconservation.org Shirley Denton*

*Conoclinium coelestinum*

## **BLUE MIST FLOWER**

**Florida Native**

*Nectar food for bees and butterflies*



*Photograph Courtesy of Missouri Botanical Gardens*

*Elephantopus elatus*

## **ELEPHANT'S FOOT**

**Florida Native**

*Attracts various pollinators*



*Photograph Courtesy of Plantatlas.usf.edu Mary Keim*

*Triodanis perfoliata*

## **CLASPING VENUS**

**Florida Native**

*Attracts various pollinators*



*Photograph Courtesy of Eleanor Dietrich*

*Asclepias incarnata*

## **SWAMP MILKWEED**

**Florida Native**

*Host plant for monarch butterfly*



*Photograph Courtesy of Missouri Botanical Gardens*



*Senna mexicana*

## **CHAPMAN SENNA**

**Florida Native**

*Host plant for sulfur butterfly*



*Photograph Courtesy of Andrea Salas*

*Sisyrinchium angustifolium*

## **BLUE-EYED GRASS**

**Florida Native**

*Attracts various pollinators*



*Photograph courtesy of Shirley Denton @plantatlas.usf.ed*

*Erigeron quercifolius*

## **FLEABANE DAISY**

**Florida Native**

*Attracts various pollinators*



*Photograph Courtesy Shirley Denton*

*Asimina obovata*

## **PAWPAW**

**Florida Native**

*Host plant for zebra swallowtail*



*Photograph Courtesy of Shirley Denton*

## *Vernonia gigantea* **GIANT IRONWEED**

**Florida Native**

*Attracts butterflies*



*Photograph Courtesy of American Meadows*

*Tripsacum floridanum*

## **DWARF FACKAHATCHEE GRASS**

**Florida Native**

*Host plant for skipper butterflies*



*Photograph Courtesy of gcrec.ifas.ufl.edu*



*Vernonanthura nudiflora*

**NARROWLEAF**

**IRONWEED**

**Florida Native**

*Attracts butterflies and bees*



*Photograph Courtesy of David Hume IFAS*

*Stachys floridana*

**FLORIDA BETONY**

**Florida Native**

*Attracts butterflies and bees*



*Photograph Courtesy inaturalist Sharpj99*



**Maintenance plan for next year (Aug. 2021 – July 2022)**

Aug 2021 – weeding, spray herbicide to kill weeds in pathway and around perimeter

Sept – weeding, chop and drop spent flower heads

Oct – weeding, mulch pathways and site perimeter

Nov – weeding, spray torpedo grass if needed

Dec – weeding, check signs and replace as needed

Jan 2022 – weeding, cut back clumping grasses, use cut material for mulch

Feb – weeding, cut back clumping grasses, use cut material for mulch

Mar – weeding, mulch pathways and site perimeter

Apr – weeding, spray herbicide to kill weeds in pathway and around perimeter

May – weeding, cut back plants from encroaching on pathways if needed

June – weeding, cut back plants from encroaching on pathways if needed

July - weeding, chop and drop spent flower heads



### **Educational Programs for Next Year (Aug. 2021 – July 2022)**

Next year we plan have monthly garden tours (Oct 2021 – May 2022) that will visit the wildflower meadow as part of our Exploration Gardens tour. We plan to have a Native Wildflower Workshop where we teach 20 participants planting from seed workshop around October 1<sup>st</sup>, 2021. Tours and classes will be advertised on Eventbrite at [www.ocextension.eventbrite.com](http://www.ocextension.eventbrite.com). We plan to do an educational video on how to plant seeds in addition to the in-person class to reach people virtually on Facebook and YouTube. We will continue to post pictures of what's in bloom in the Wildflower Meadow on Garden Florida! Facebook page <https://www.facebook.com/GardenFlorida> and Instagram [https://www.instagram.com/oc\\_extension/](https://www.instagram.com/oc_extension/). We would also like to invite a speaker from the Florida Wildflower Foundation to do a talk next spring.